

## CLIENT VIEW - DYNAMIC

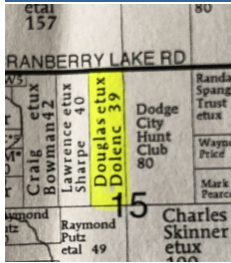

**MLS #** 50039741  
**Address** 40 acres Cranberry Lake Road  
**Area (Municipality)** Hamilton Twp (18008)  
**Mail City** Harrison  
**County** Clare  
**State** MI  
**Zip** 48625  
**Class** VACANT LAND  
**Type** Vacant Land  
**Sale/Rent** For Sale  
**Status** Active  
**Asking Price** \$99,900



## PUBLIC REMARKS

**Public Remarks** 40 Rolling Wooded acres offers great deer hunting. Mixture of trees include many red pines, large oak trees, poplar, cedar and mix of hardwoods. One spot drops into a cedar swamp. Adjoins the Dodge City Hunt Club on the East side. Don't miss out on this one! Call today!

## LISTING INFORMATION

<b>Full Address(es)</b>	40 acres Cranberry Lake Road, Harrison, MI 48625	<b>FIPS</b>	26035
<b>Input Date</b>	4/23/2021 9:40 PM	<b>Original MLS#</b>	50039741
<b>Originating MLS</b>	Clare Gladwin Board of REALTORS	<b>Original Price</b>	\$109,900
<b>Price Date</b>	6/7/2021	<b>Listing Date</b>	4/23/2021
<b>Listing Exception Y/N</b>	No	<b>Expiration Date</b>	10/23/2021
<b>Update Date</b>	6/7/2021	<b>HotSheet Date</b>	6/7/2021
<b>Status Date</b>	4/23/2021	<b>Days On Market</b>	53
<b>Cumulative DOM</b>	53	<b>Days On MLS</b>	53
<b>Cumulative DOMLS</b>	53	<b>Signed Disclosure Y/N</b>	Yes
<b>Guest Listings Y/N</b>	No	<b>Contract</b>	Exclusive Right to Sell
<b>Lease Y/N</b>	No	<b>Additional Documents YN</b>	No
<b>Associated Document Count</b>	1	<b>Picture Count</b>	21

## PROPERTY & LOCATION

<b>Style</b>	Vacant Land	<b>Survey On File Y/N</b>	No
<b>Site Condo Y/N</b>	No	<b>Waterfront Y/N</b>	No
<b>Frontage</b>	660	<b>Lot Size</b>	660x2340
<b>Acreage</b>	40.00	<b>Cross Street 1</b>	Cranberry Lake Road
<b>Cross Street 2</b>	Athey	<b>Directions</b>	M61 to Athey North to Cranberry Lake Rd, right to property on right
<b>Side of Street</b>	S	<b>Municipality</b>	Hamilton Twp
<b>Municipality Type</b>	Township	<b>School District</b>	Harrison Community Schools
<b>Property ID</b>	008-015-100-22	<b>PropertyIDAlt</b>	26035+00801510022

## TAX & FINANCIAL

<b>Tax ID</b>	26035	<b>Subj to Short Sale Apprvl</b>	No
<b>Ownership</b>	Private	<b>Owners Name</b>	Dolenc
<b>Association Y/N</b>	No	<b>Assessments Y/N</b>	No
<b>Principal Res Exempt Y/N</b>	No	<b>Summer Tax Year</b>	2020
<b>Summer Tax Amount</b>	373.27	<b>Winter Tax Year</b>	2020
<b>Winter Tax Amount</b>	1037.68	<b>Total Tax Year</b>	2020
<b>Total Tax Amount</b>	1410.95	<b>SEV Year</b>	2020
<b>SEV</b>	34600.00	<b>Taxable Value</b>	\$33,847.00

## FEATURES

<b>LOCATION</b>	Rural	<b>FINANCIAL TERMS</b>	Cash	<b>SEWER SEPTIC</b>	None
<b>LOT DESCRIPTION</b>	Rolling/Hilly		Conventional	<b>WATER</b>	None
	Unpaved	<b>ROADS</b>	Gravel	<b>ZONING</b>	Residential
	Wooded				

## MARKETING-VIRT TOURS/IDX/VOW

<b>VOW Include</b>	Yes	<b>VOW Address</b>	Yes
--------------------	-----	--------------------	-----

MARKETING-VIRT TOURS/IDX/VOW

VOW Comment	No	VOW AVM	Yes
IDX Consumer Comment	No	IDX Automated Valuation	Yes
IDX Include	Y	Public GLR Websites	Yes
Public MiRS Website	Yes		

LEGAL DESCRIPTION

Legal Description T19N R3W SEC 15 E 40 ACRES OF E 1/2 OF NW 1/4. FROM 100-15 2007 SPLIT

ADDITIONAL PICTURES



DISCLAIMER

This information is deemed reliable, but not guaranteed. All room dimensions are in appx. feet.